

INDULCLIP Frontplatte

Ausblascharakteristik - asymmetrisch

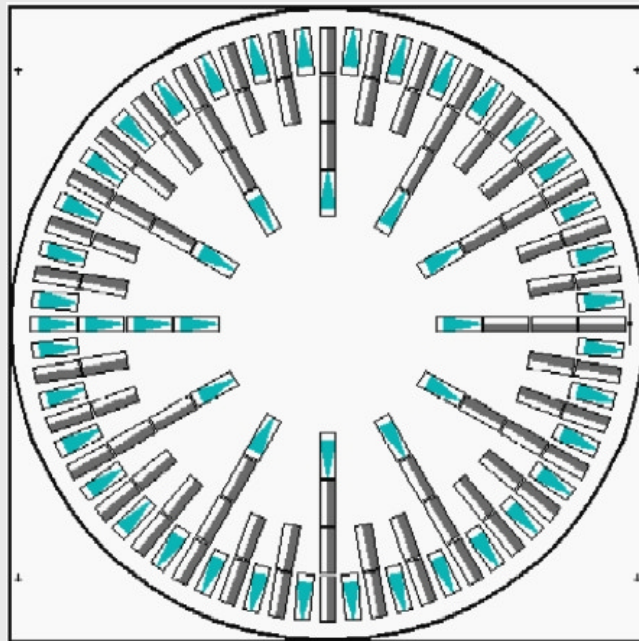
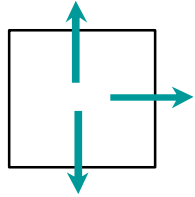

Deckenplatte R 800

Clip Typ P20W :

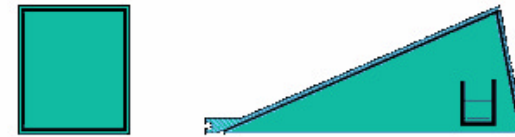

Symbol 

Clip Typ C20 :

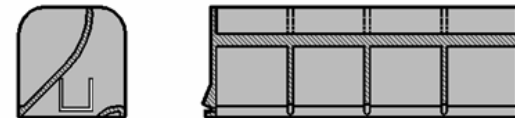

Symbol 

INDULCLIP Frontplatte

Ausblascharakteristik - symmetrisch

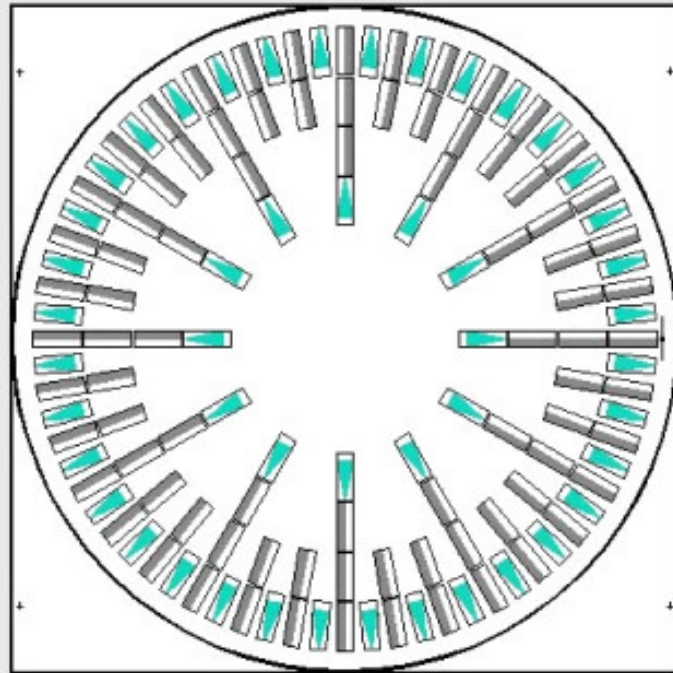
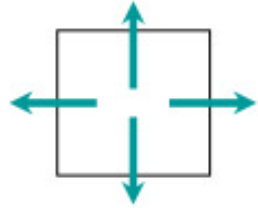

Deckenplatte R 800

Clip Typ P20W :

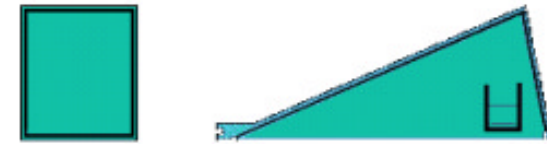

Symbol 

Clip Typ C20 :

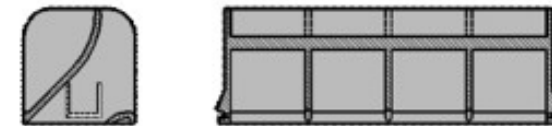

Symbol 

Luftverteilkasten mit Drosseleinrichtung

4 Eckwinkel
15 x 15 mm,
75 mm lang
(Nicht bei Nenn-
größe 300x300)

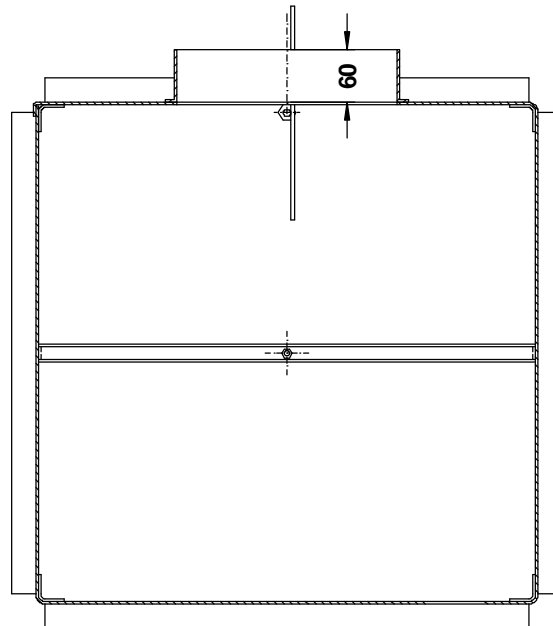
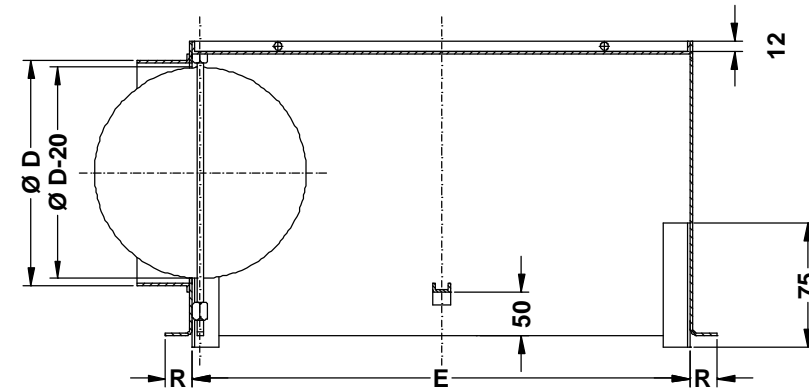
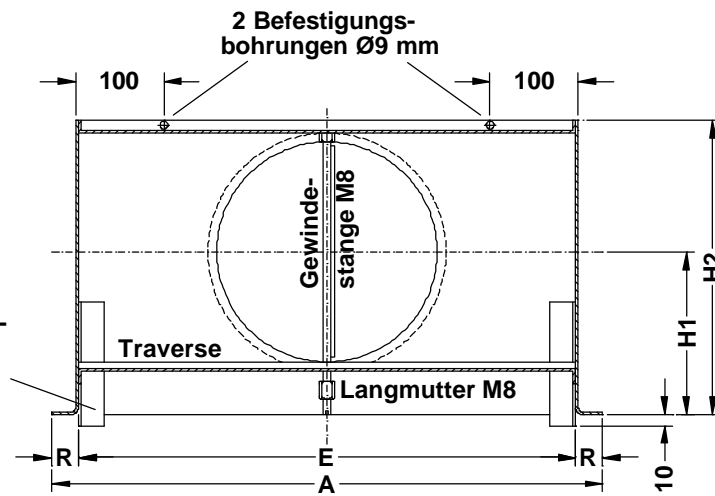

verzinktes Stahlblech
Mindest- Blechstärke je Größe nach DIN 24190
alle Schweißpunkte kaltverzinkt